

Gallagher F3 Fence Controllers



A single energizer platform that does everything from simple single fence zone protection to complex multi-controller, multi technology, fully networked solutions.

Gallagher F3 Fence Controllers Features

Two Variants

Available in two versions, a single circuit (F31), and a double circuit (F32).

Two Configurations

Deployable as a stand-alone fence controller (for use with an alarm panel), or as a fully networked controller with a full suite of integrated capabilities. Configurations can be changed easily with an onboard switch.

Dual Pulse

The F32 controller can be configured as a single dual pulse zone with alternate positive and negative pulse on fence wires for twice the deterrent.

User Interface

The controller has an intuitive visual interface developed to give instant system and fence circuit information.

Synchronization

Low and High Voltage synchronization options allow for safe and compliant operation.

Low Feel Voltage

The Low Feel setting allows fence circuits to be monitored while operating at a decreased deterrent level.

Service Mode & Magnetic Key

Service mode allows an operator to control zones while fault finding and testing. A magnetic key allows historic alarm indications to be cleared and, when in service mode, circuits can also be turned on and off.

Alarms

The F3 Controllers create alarms for a variety of events, including: fence voltage drop, power supply failure, tamper, over-temperature, and synchronization loss or battery test failure.

Power Management

Enhanced battery management ensures efficient battery charging, extended charge duration, and automatic backup testing.

Temperature Management

Internal sensors continuously monitor temperatures and the F3 will adjust behavior automatically to protect the controller and maintain security.

Cable Manager

Optional storage module and cable cover for tidy cabinets.

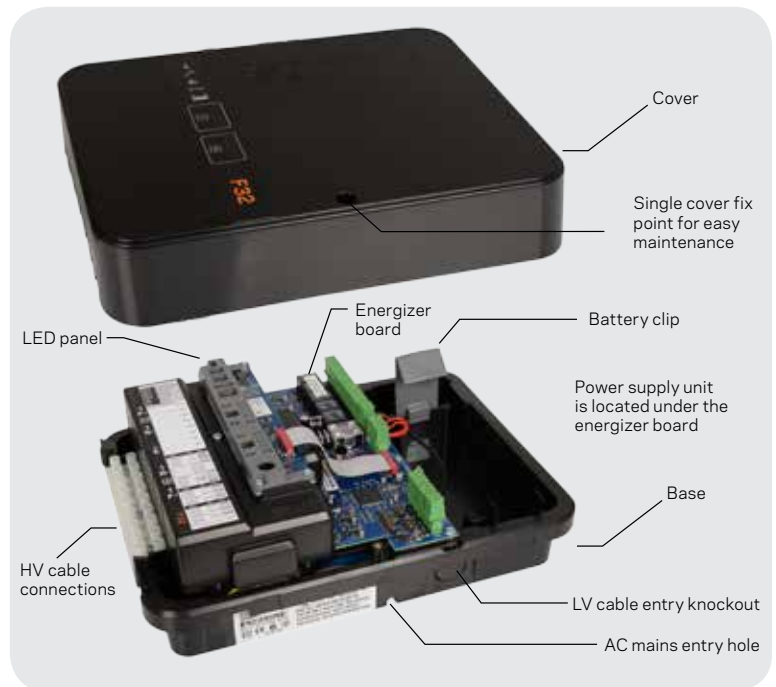

F31 Fence Controller - G21920

F32 Fence Controller - G21940



Magnetic Key - G21963

F3 Cable Manager - G21965





Gallagher F3 Fence Controllers

PART NUMBERS

| | | | | | |
|--------|----------------------|--------|------------------|--------|-----------------------|
| G21920 | F31 Fence Controller | G21963 | Magnetic Key | G21961 | Power Supply 15V 2.4A |
| G21940 | F32 Fence Controller | G21965 | F3 Cable Manager | | |

Technical Specifications

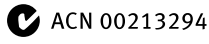
| F3 FENCE CONTROLLERS | | F31 | F32 |
|--|---|---|--|
| Fence Controller | Power Supply Voltage | 90 - 265 V AC, 50 / 60 Hz | 90 - 265 V AC, 50 / 60 Hz |
| | Power Consumption | 30 W | 36 W |
| | Software (network only) | Command Centre v7.40 or above | Command Centre v7.40 or above |
| Aux. DC output | | 11 - 15 V 0.7A (re-settable fuse) | 11 - 15 V 0.7A (re-settable fuse) |
| Inputs | 4-State balanced inputs | 2 | 3 |
| Outputs | Dry contact relays | 4 | 5 |
| Communications | Max contact rating | 12 A at 20 V DC / AC RMS | 12 A at 20 V DC / AC RMS |
| | Between Gallagher Controller HBUS port and Gallagher F3 Fence Controller | RS485 at 1Mbps/s | RS485 at 1Mbps/s |
| | Wiring format - data | 2 wire | 2 wire |
| Cable distance | Encryption level | 128 bit AES | 128 bit AES |
| | F3 Fence Controller to Gallagher Controller 6000 | 500 m (1640 ft) maximum (non-shielded twisted pair) | 500 m (1640 ft) maximum (non-shielded twisted pair) |
| | Sync Options | LV | LV/HV |
| LV Sync Cable Limit | | 1.2km CAT5e/ Copper, 50km Fibre | |
| Maximum recommended number of F3 Controllers per HBUS port on a C6000 | | 24 | 24 |
| Number of fence circuits | | 1 | 2 |
| Maximum recommended fence zone length | | 300 m (984 ft)* | 300 m (984 ft)* |
| Maximum HV circuit resistance | | 300 Ω* | 300 Ω* |
| * While the energy of this unit allows up to a maximum of 300m (984ft) - the classification of risk, elevations in the fence, and terrain dictate the length of a zone for security evaluation | | | |
| Energizer | Output per circuit | 2.3 J | 2.3 J |
| | High Voltage | 100% Nom 8.0kV (wire to earth) [†] | 100% Nom 8.0kV (wire to earth) [†] |
| | High Voltage Dual Pulse | 100% Nom 16.0kV (-wire to +wire) [†] | 100% Nom 16.0kV (-wire to +wire) [†] |
| | Low Feel | 100% 1.0kV (500Ω) [†] 10% 0.4kV (500Ω) [†] | 100% 1.0kV (500Ω) [†] 10% 0.4kV (500Ω) [†] |
| | Pulse Rate | 1 pulse per 1.5sec [†] | 1 pulse per 1.5sec [†] |
| † Default values in stand-alone, and configurable in Command Centre when using network mode | | | |
| Temperature range | Portrait | -20° to +40° C (-4° to +104° F) | -20° to +40° C (-4° to +104° F) |
| | Landscape | -20° to +50° C (-4° to +122° F) | -20° to +50° C (-4° to +122° F) |
| Environmental protection rating | | IPX4 | IPX4 |
| Internal back up battery | 7 Ah / 12V DC | 14 hours coverage on default settings | 10 hours coverage on default settings |
| Compliance standards | C-Tick, FCC, ROHS, CE, EN 60335-2-76:2005 + A2:2015, AS/NZS 60335.2.76:2003 Edition 2.1 inc A1, A2, A3 IEC 60335-2-76:2002 Edition 2.2 inc A1:2006 + A2:2013 SANS 60335-2-76:2006 Edition 2.1 | |     |

Dimensions

| F3 FENCE CONTROLLERS | | F31 | F32 |
|----------------------|------------------------|---|---|
| Dimensions | Height x Width x Depth | 255 x 340 x 120 mm (10 x 13.4 x 4.7 in) | 255 x 340 x 120 mm (10 x 13.4 x 4.7 in) |
| | Weight | 2.95 kg (6.5 lb) | 3.75 kg (8.27 lb) |

| F3 SERIES CABLE MANAGER | |
|-------------------------|--|
| Dimensions | Height x Width x Depth 255 x 112 x 120 mm (10 x 4.4 x 4.7 in) |

GALLAGHER WORLD HEADQUARTERS

Kahikatea Drive, Hamilton 3206
Private Bag 3026, Hamilton 3240
New Zealand

TEL: +64 7 838 9800
EMAIL: security@gallagher.com



REGIONAL OFFICES

New Zealand..... +64 7 838 9800
Americas..... +1 877 560 6308
Asia +852 3468 5175
Australia +61 3 9308 7722
India +91 80 2661 1590
Middle East..... +9615 808728
South Africa +27 11 974 4740
United Kingdom / Europe..... +44 2476 64 1234

DISCLAIMER: This document gives certain information about products and/or services provided by Gallagher Group Limited or its related companies (referred to as "Gallagher Group"). The information is indicative only and is subject to change without notice meaning it may be out of date at any given time. Although every commercially reasonable effort has been taken to ensure the quality and accuracy of the information, Gallagher Group makes no representation as to its accuracy or completeness and it should not be relied on as such. To the extent permitted by law, all express or implied, or other representations or warranties in relation to the information are expressly excluded. Neither Gallagher Group nor any of its directors, employees or other representatives shall be responsible for any loss that you may incur, either directly or indirectly, arising from any use or decisions based on the information provided. Except where stated otherwise, the information is subject to copyright owned by Gallagher Group and you may not sell it without permission. Gallagher Group is the owner of all trade marks reproduced in this information. All trademarks which are not the property of Gallagher Group, are acknowledged. Copyright © Gallagher Group Ltd 2015. All rights reserved.

3E39396-09/15

